

COVID Email Update 28 June 2021 (dyslexia friendly version)

Good afternoon to you all, I hope you and your families are all doing okay.

For anyone who was in 5PS last week, you'll have noticed that the signs on our 7th floor seats have gone. They needed to be removed for the deep clean. There have also been some slight changes to our seats on the 7th floor, and we now also have additional seats on the 4th floor.

Tomorrow, I will be putting signs on our assigned seats. This time, the seats won't be assigned to individuals and you can sit in any of the marked FSCF seats. We will keep our bubbles until the final stage of lockdown is lifted. We have 42 seats across the 7th and 4th floor. I will put the information below on the Guidebook here <https://ascpractice.camden.gov.uk/early-help-guide/family-early-help-covid-guidebook/fscf-procedures-during-covid/>

BUT A BIG ASK PLEASE – Corporate still do not want us to have whole teams together at any one time because of concerns that if one team member gets COVID, the infection could spread to a whole team. So even though we have a bit more flex to come and go from 5PS, please do stick to your bubble rotas until further notice and remember there are still limits on the number of people allowed in meeting rooms and social distancing in the building is still in force.

Here is the map of our new seats on the 7th floor (ours are the dark blue ones):



And here is the map of our new seats on the 4th floor (again dark blue ones):

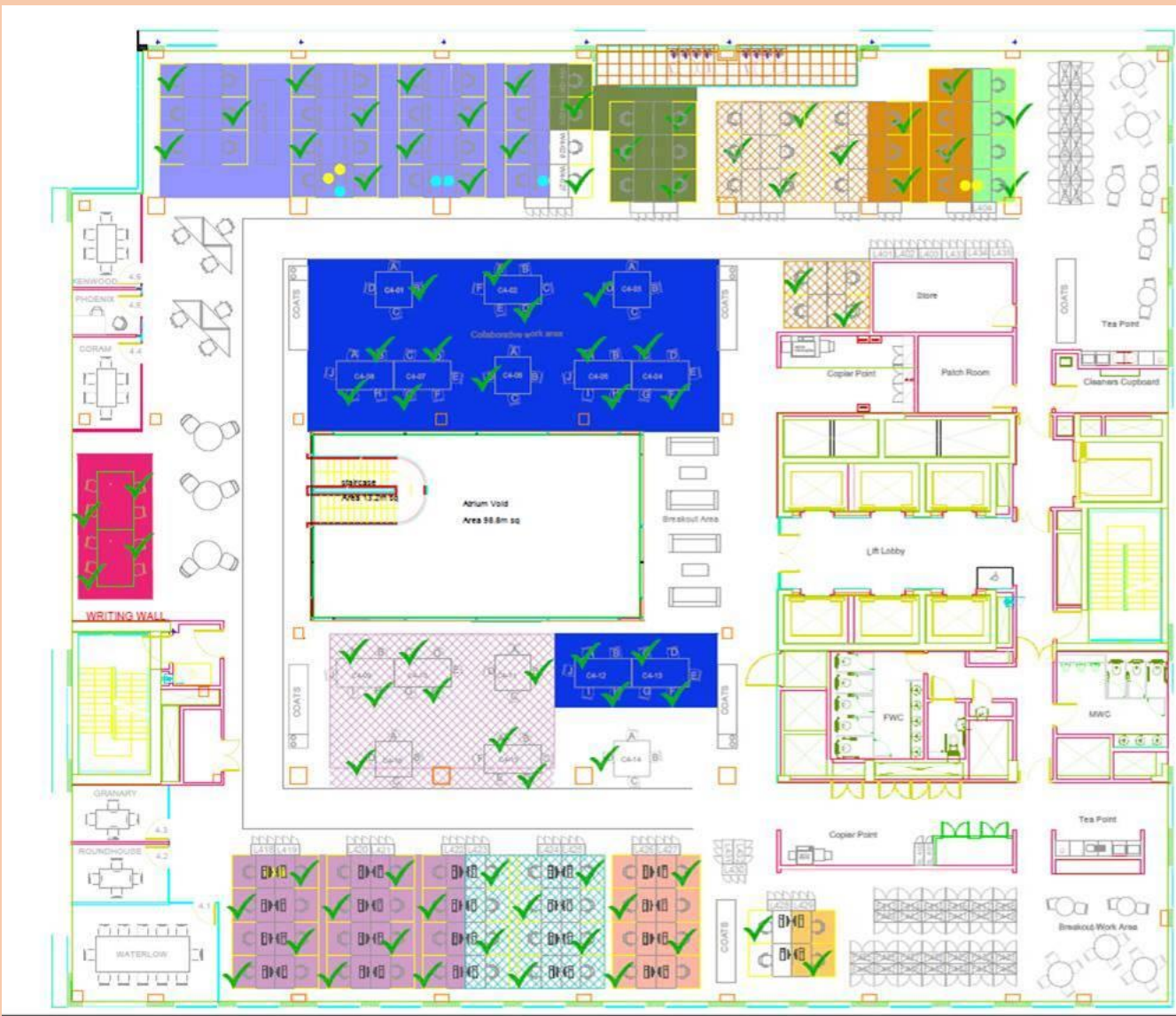

REVISED
22nd June 2021

- COUNCIL TAX P1 - 4
- COUNCIL TAX P2 - 8
- FINANCE P1 - 2
- FAMILY SUPPORT P1 - 17
- EARLY YEARS P1 - 13
- SPORTS & PHYSICAL ACTIVITY P1 - 4
- GREEN SPACES P1 - 16
- GREEN SPACES P2 - 8
- BENEFITS P1 - 1
- SUPPORTING COMMUNITY DIRECTORS P1 - 9
- MENTAL HEALTH & LEARNING DISABILITY P2 - 2
- CHILDRENS COMMISSIONING P2 - 1
- COMMISSIONING P2 - 2
- TEMPORARY ACCOMMODATION P1 - 4

- ✓ Seating
- indicates available seats in other areas.

| Rev | Amendment Details | Date | By |
|--|-------------------|------------------------|--------------------------|
| | | | |
| Project and Consultancy Services Strategy and Projects Team Level 3 5 Pancras Square London N1C 4AG CAD Manager: C O'Hall E: c.ohall@camden.gov.uk T: 020 7874 1870 | | | |
| Property | | | |
| 5 Pancras Square | | | |
| Floor: Level 4 | | | |
| Drawing Title: | | | |
| SOCIAL DISTANCING LAYOUT 2 meters apart. | | | |
| Drawn by: COR | Checked by: KH | Issued by: 14/03/14 | Rev 5/1/16 A3 N798 |
| 22-06-21-PS-4-SD-2M | | | |

Updates for you this week:

Mental Health Support Team Parent Webinar Summer 2021

The Mental Health Support Team (MHST) are running a webinar for Camden parents on the topics of structure, routine and summer activities on 2 July 9.30 – 11am on Teams. Parents and carers can register for free at <https://www.eventbrite.co.uk/e/mhst-parent-and-carer-wellbeing-webinar-series-tickets-154740568205>.

Parking Permits

You will have seen on Essentials that the enhanced parking permit scheme, where Camden staff can access free parking permits if their individual risk assessment suggests this is needed, will end on Friday 30 July. Our colleagues in Parking tell us that this is due to the final set of lockdown restrictions due to be eased on 19 July, and the continued rollout of the vaccination programme.

I'm mindful this will affect a number of you who have temporary parking permits, and that you may feel worried about what this means for you. Please do talk with your line manager about it, and particularly update your individual risk assessment. I will gladly take up individual cases with my counterpart in Parking Services if we feel strongly that not being able to use your car for work will have a significant effect on the risk to your health.

NVR Groups Starting Again

The next Non-Violent Resistance (NVR) group from the Tavi's whole family team will be starting again in late September. The programme will run for 13 weeks, and the hope is to make it face to face (but may move online if needed). Families open to the whole family team will take priority, but referrals are welcome as well. If you have a family who you think might benefit from the NVR approach, please complete the NVR referral form on the Guidebook here <https://ascpractice.camden.gov.uk/early-help-guide/family-early-help-covid-guidebook/conflict-or-violence-in-the-home/child-to-parent-violence/> and return to LACAMHSADMIN@camden.gov.uk by **Friday 11th September 2020**.

In some circumstances where an NVR group is not suitable, the Tavi may be able to offer individual work (but will assess on a case by case basis). If you want to discuss a referral first, you can contact Kate O'Brien (clinical psychologist) on 07525 289 029 and Alex Duckworth (CAMHS Community Nurse) on 07817 900828

Child Employment Permits for Summer Holidays

Employers who employ children aged 13 – 16 need to apply for an employment permit from the council where the business is based. If you're working with a young person who is employed, particularly over the summer, please help ensure their employment rights and their children's rights are protected by helping them make sure their employer has this permit.

The child employment officer advise employers about completing the application form, and they can be contacted at ce@camden.gov.uk. You can find more details about the work that children can do and how to apply for a permit in the leaflets on the [Camden website](#) or on the [government's website](#). More information on the attached email.

Vaccinations Now Available for People Aged 18 and Over + Vaccination Sites on Google Maps

A reminder that vaccinations are now available for all people aged 18 and over. Camden CCG have also created a Google Maps showing all the venues offering vaccination in the borough.

You can find this map, plus more information about booking vaccinations including the booking link, on the Guidebook here <https://ascpractice.camden.gov.uk/early-help-guide/family-early-help-covid-guidebook/covid-nhs-and-government-information/vaccinations/#main>

Camden COVID Updates Now in British Sign Language

Camden's weekly updates on COVID in the borough are now available in BSL. You can find the latest video here <https://www.youtube.com/watch?v=J3y6yWdcQwE>

Last Weeks Survey – Your Questions Answered

Couple of queries in last week's survey:

| | |
|--------------------------------------|---|
| Where can I find masks at 5PS? | All our PPE is in the FIF cupboard on the 9 th floor. Here is a link to one of our weekly bulletins which shows you where to find it. I will be checking stock tomorrow to make sure its replenished if needed https://ascpractice.camden.gov.uk/media/2765/covid-email-update-26-april-2021.pdf |
| How can we send letters to families? | You can use Mailsmart – more information here https://ascpractice.camden.gov.uk/early-help-guide/family-early-help-covid-guidebook/technology-for-workers/mail-smart/#main if you need a letter or document printing, you can either pop into 5PS on your bubble week, or ask your manager if they can print it when they are next in 5PS. |

Weekly Survey

This week's family needs survey, for you to raise any issues you're seeing and noticing for families and anything you might need yourself, is now open here [FSCF FAMILY NEEDS SURVEY W/C 28 JUNE 2021](#)

New information uploaded to the COVID Guidebook this week link here <https://ascpractice.camden.gov.uk/early-help-guide/family-early-help-covid-guidebook/>

| | | |
|---|--|--|
| <p>Vaccination Sites in Camden</p> <p>Link to Google Map showing all the venues offering vaccination in the borough</p> <p>https://ascpractice.camden.gov.uk/early-help-guide/family-early-help-covid-guidebook/covid-nhs-and-government-information/vaccinations/#main</p> | | |
|---|--|--|

We are now in week 67 of COVID and our capacity continues to hold steady.

I'll end this week with an image from the first ever presentation I gave in Camden 5 years ago (which was to FIFers!) and its connection with Bronfenbrenner's ecological systems model. Bronfenbrenner believed that there were multiple systems that impact on a child's health and wellbeing and all of them needed to be explored and reflected on.

Thinking about these layers not only helps us to locate the child in their broad community and societal context, but it is also incredibly important to our work on racial justice and equity. Many of you will be familiar with the social ecology model and it's well worth a look (8 minute video here) <https://www.youtube.com/watch?v=nULPGD0N6WM>

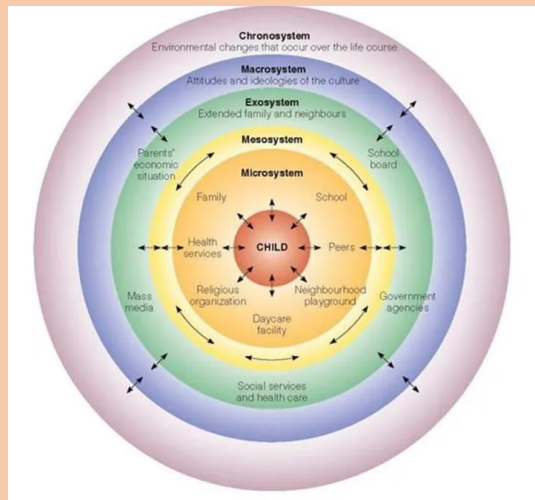
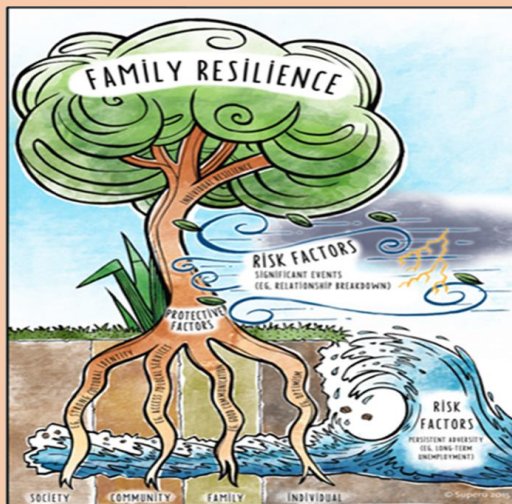

Stay safe and well and, as ever, shout me if there is anything you need.

Becca

Becca Dove

Head of Family Support and Complex Families